



# VAUCLUSE ESTATE

EST. TASMANIA 1825



## WEDDING GUIDE

2024-2025



## Your Wedding

Just a short drive from Launceston, yet a world away, Vaucluse Estate offers a wedding venue with stunning 360 degree views of Tasmanian lush land and sweeping mountains. It's an iconic setting for a wedding that you and your guests will long remember.

Picture your incredible day celebrating on our poolside manicured lawns, or dancing along our 200 year old heritage verandah, with a backdrop complete with glorious vistas every way you turn.

Whatever your celebration, we look forward to being the perfect accompaniment for your special day.





## Our Facilities

Enjoy exclusive use of this picture perfect property by saying, “I do,” under our willow tree in the ceremony garden, before drinks at dusk on the verandah, then moving to a reception alongside views of Ben Lomond. There are 12 master suites for you and your guests, with exclusive use of event space and all hotel facilities.

- Exclusive use of the premises and accommodation
- 12 x bedrooms rooms across the Coach House and Hotel buildings
- 6 x main event areas; Long Verandah, Ceremony Lawn, Eastern Pool Lawn, Drawing Room, Glass Conservatory, and Orchard
- 5 x public use toilet facilities
- Commercial kitchen
- Outdoor pool
- Crockery, cutlery, glassware, table linen for 110 people
- Long tables and Bentwood-style white chairs for 110 people
- BBQ

*Image: Wedding Styling by Artaud & Co.*





## Exclusive Venue Hire

We offer a caring, inclusive approach and work with you to ensure you have every detail perfectly covered.

Bring your chef, caterer, musician, planner or stylist, and we provide the event space, accommodation, and beverages.

## Capacity

### Ceremony Locations

- Eastern Lawns - 100+ seats
- Ceremony Gardens - 100+ seats
- Hotel Drawing Room - 30 seats
- Verandah - 90 seats

### Reception Locations

- Eastern Lawns - 100 + seats
- Ceremony Gardens - 100 + seats
- Hotel Drawing Room - 18 seats
- Verandah - 80 seats





## Beverage Selection

We have a carefully curated beverage list and offer both price-per-head beverage packages or on-consumption options.

If you have a favourite cocktail, wine, or aperitif, let us know- we happily customise your drinks list with you.

## Catering

Whether your style is fine dining, a fire-roasted feast, or delicious shared plates, there are incredible Tasmanian caterers who work with the best local produce and people.

Your catering team has full access to our well-equipped commercial kitchen.





## Accommodation

Whether a destination wedding, or even a smaller wedding party, our accommodation suites aim to provide that extra touch of decadence for your guests.

We can host up to 28 guests across the property.

## Inclusions

- Accessible ground floor suite
- Three-storey lift for luggage transportation
- Continental breakfast each morning
- 9 Queen Bed Suites in the Main Hotel Building
- 1 x Queen Bed Suite, 1 x Twin Bed Suite, and 1 x 2 Queen Bed Suite in the Coach House Building
- 3.00pm Check-in, and 11.00am Check-Out
- Exclusive use of the property for you and your guests





## Preferred Suppliers

Vaucluse Estate is privileged to work with some of the best wedding suppliers. An in-house celebrant is available to officiate your wedding if you desire.

We happily offer our expertise and suggestions to assist you with your planning.

## Vaucluse Minimum Spends

We provide an individual quotation based on your event requirements, based on two or three-night exclusive use of the property.

Two night exclusive use, starting from \$15,070 inc. GST

Three night exclusive use, starting from \$20,820 inc. GST

Please also contact us to discuss smaller group, or short or long stays.

## Wet Weather Options

We have on-site options for wet weather plans. Marquees can be arranged. Pricing is subject to size and style.



# Property - Site Plan

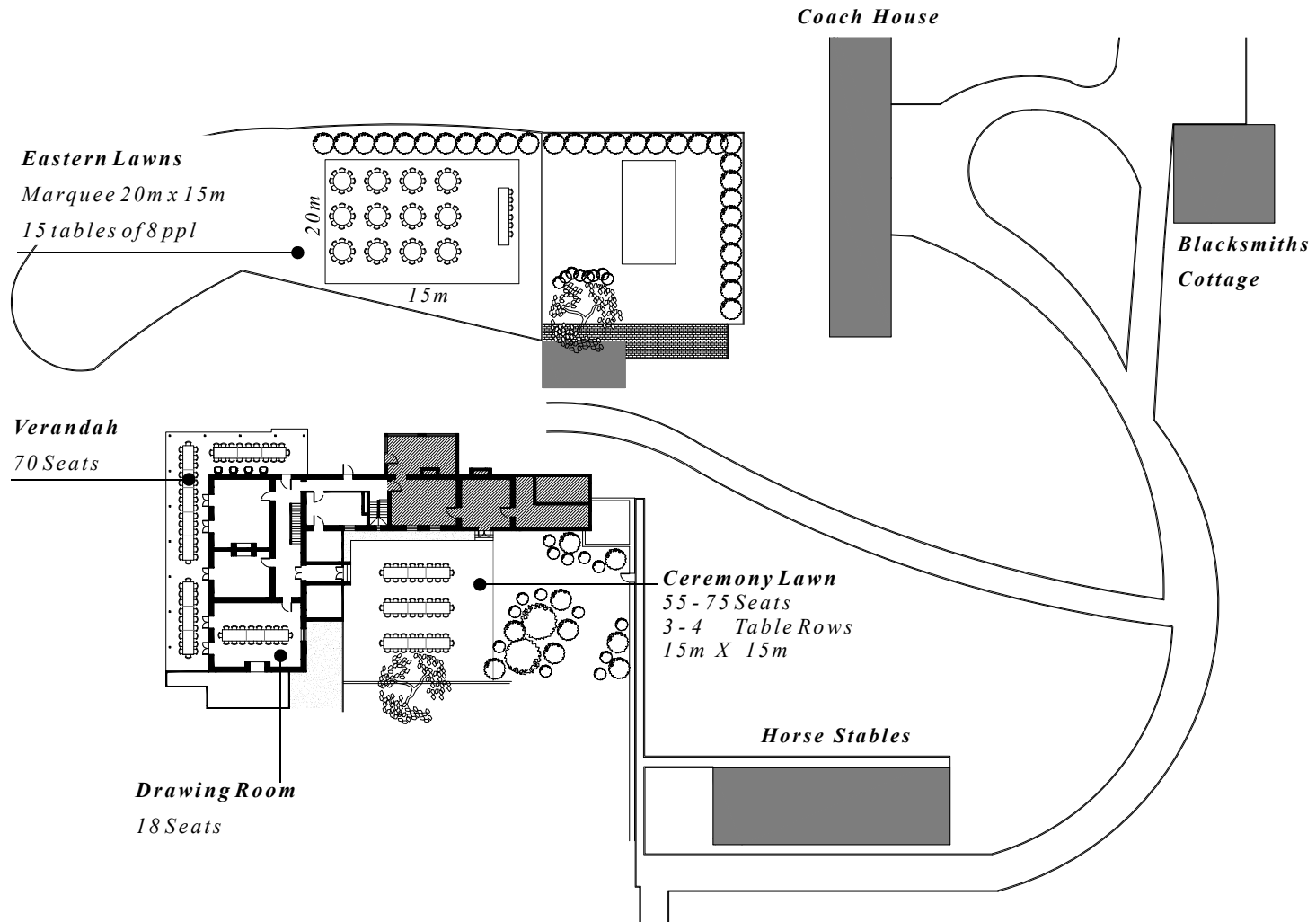





## Deposit

A deposit of 20% of your total invoice is required to confirm your event, and is payable at the time of signing your contract.

40% of the total is due 90 days prior to the event date, and the final remaining payment is due 30 days prior to the event date.

Weddings held across public holiday dates will incur a surcharge of 5% of the total bill. Prices may vary, are subject to availability and relevant until March 2024.

All prices quoted are GST exclusive.

Total amounts including GST will be clearly outlined in quotes and invoicing.





## Contact

For more information or to arrange an on-site preview and quotation, contact [enquiries@vaclusetasmania.com.au](mailto:enquiries@vaclusetasmania.com.au)

The materials and information in this document have been prepared and assembled for marketing and informational purposes only.

Please contact us for individualised quotes and pricing.

All prices in compendium are applicable until 31st July 2024.

[www.vaclusetasmania.com.au](http://www.vaclusetasmania.com.au)





*All images provided by DOXA Visual with thanks.*

